

WELCOME TO THE

Pennsylvania State Capitol

The Pennsylvania State Capitol is open to the public, Monday through Friday, regular weekdays from 7 a.m. until 6 p.m.

Weekends and holidays, the building is secured and access is limited to the Main Rotunda from 8:45 a.m. until 4 p.m., unless accompanied by a Capitol Tour Guide.

Guided Capitol tours are offered regular weekdays every half hour from 8:30 a.m. through 4 p.m.; and at 9 a.m., 11 a.m., 1 p.m. and 3 p.m. weekends and most holidays. Walk-ins welcome.

Reservations are required for groups of 10 or more. For additional information on Capitol tours and to book online go to www.pacapitol.com or call (800) 868-7672.

The Pennsylvania Capitol Shop is located off the East Wing Rotunda and is open regular weekdays from 9:30 a.m. to 3:30 p.m.

The Welcome Center, located in the East Wing and open Monday through Friday from 8:30 a.m. to 4:30 p.m., offers fun and informative self-guided interactive displays to help visitors learn more about Pennsylvania and state government

Provided by





Capitol Visitor Services • (800) 868-7672

www.pacapitol.com

Regular Weekdays Only

FREE Download the Pennsylvania Capitol SELF-GUIDED TOUR MOBILE APP!

Maps of the Capitol • Videos • Kids Activities and more!



Google Play and the Google Play logo are trademarks of Google LLC. Apple and the Apple logo are trademarks of Apple Inc., registered in the U.S. and other countries. App Store is a service mark of Apple Inc., registered in the U.S. and other countries.



@PaCapitolTours

Safety Tips

Identify the EXITS in the event of an emergency.

Please monitor the children in your care.

Follow safety guidelines on escalators to avoid injury.

Look where you walk. Although looking up often to view art and architecture, you may be approaching a staircase.

When viewing the Rotunda from upper levels, do not lean over the railing – keep feet on the floor at all times.

Your cooperation with security is important. Security is present to protect everyone – those who work within the building and those who visit.



Access Routes Included

Finding Your Way Around The

Pennsylvania State Capitol



www.pacapitol.com

Room Locations for the Capitol and East Wing

	North Wing Senate	South Wing House	Front & Rear Rotunda	East Wing
Basement	38-59	2-31	B1B, B1, B2, Vending Machines, Bill Rooms	Lower Level South: 1E-39E Lower Level North: 40E-89E & Welcome Center
First Floor	156-188	110-140	100, 101 (front) 144-153 (back)	Upper Level: 101-125 (south) 141-164 (north)
E-Floor (Entresol)	531-549A	508-517	519-528 (back)	
Second Floor	264-299	225-238	200-202 (front) 216-245, Mail Room	
Third Floor	337-366	304-316	300 (north) 302 (south) 322-333	
Fourth Floor	451-468	406A-428	401, Senate & House Galleries (front), Supreme Court Room, 431-439 (back)	
Fifth Floor	632-648	603 - 629	600-602 (front) 629-630	

Main Capitol Basement and Lower (Concourse) Level East Wing

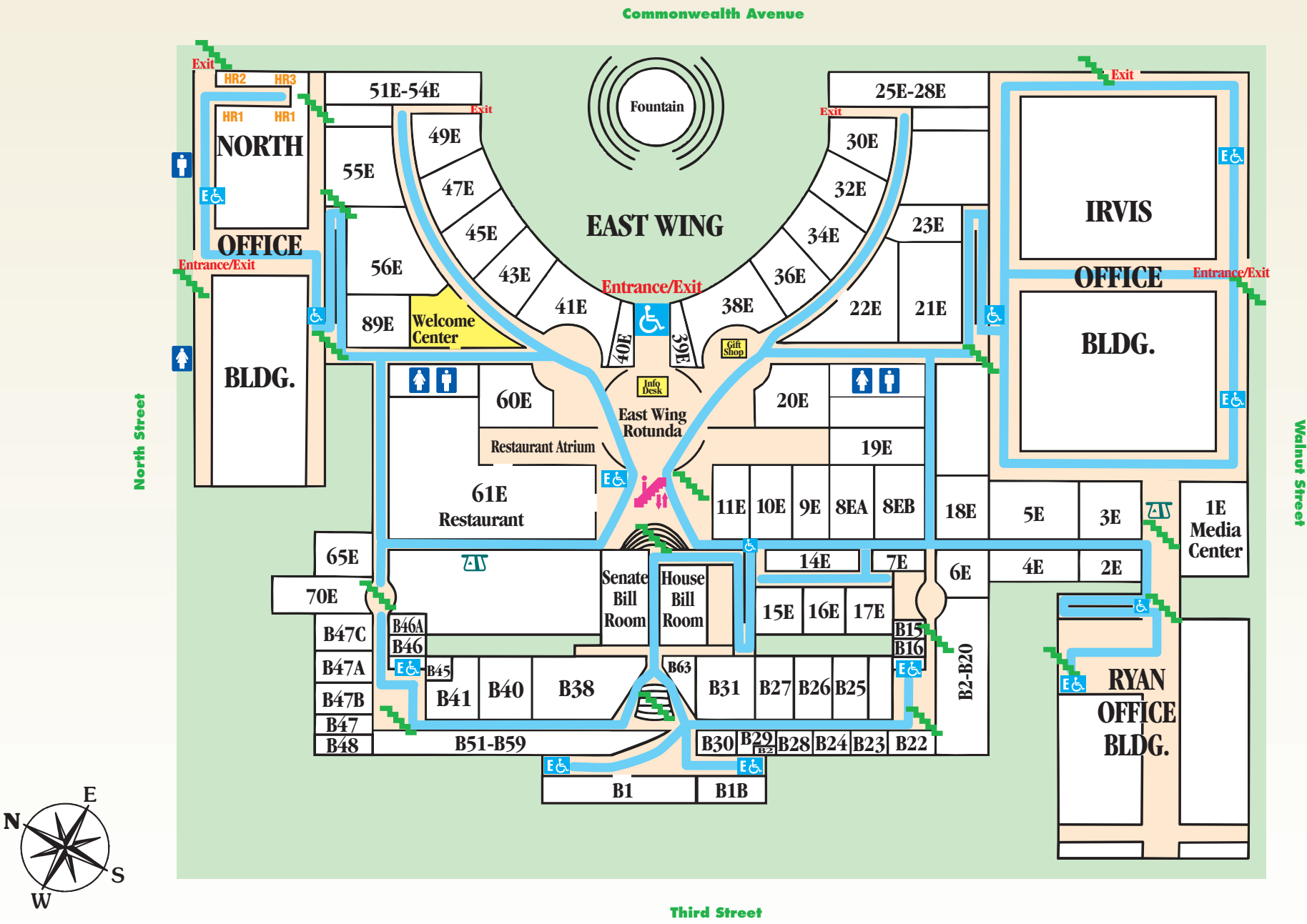

KEY:

- | | | | | | |
|---------------------|--------------|--------|----------------|--------------------|------------------|
| Access | Hearing Room | ATM | Escalator | Ladies Restroom | Interior Walkway |
| Accessible Elevator | Elevator | Stairs | Men's Restroom | Accessible Walkway | |

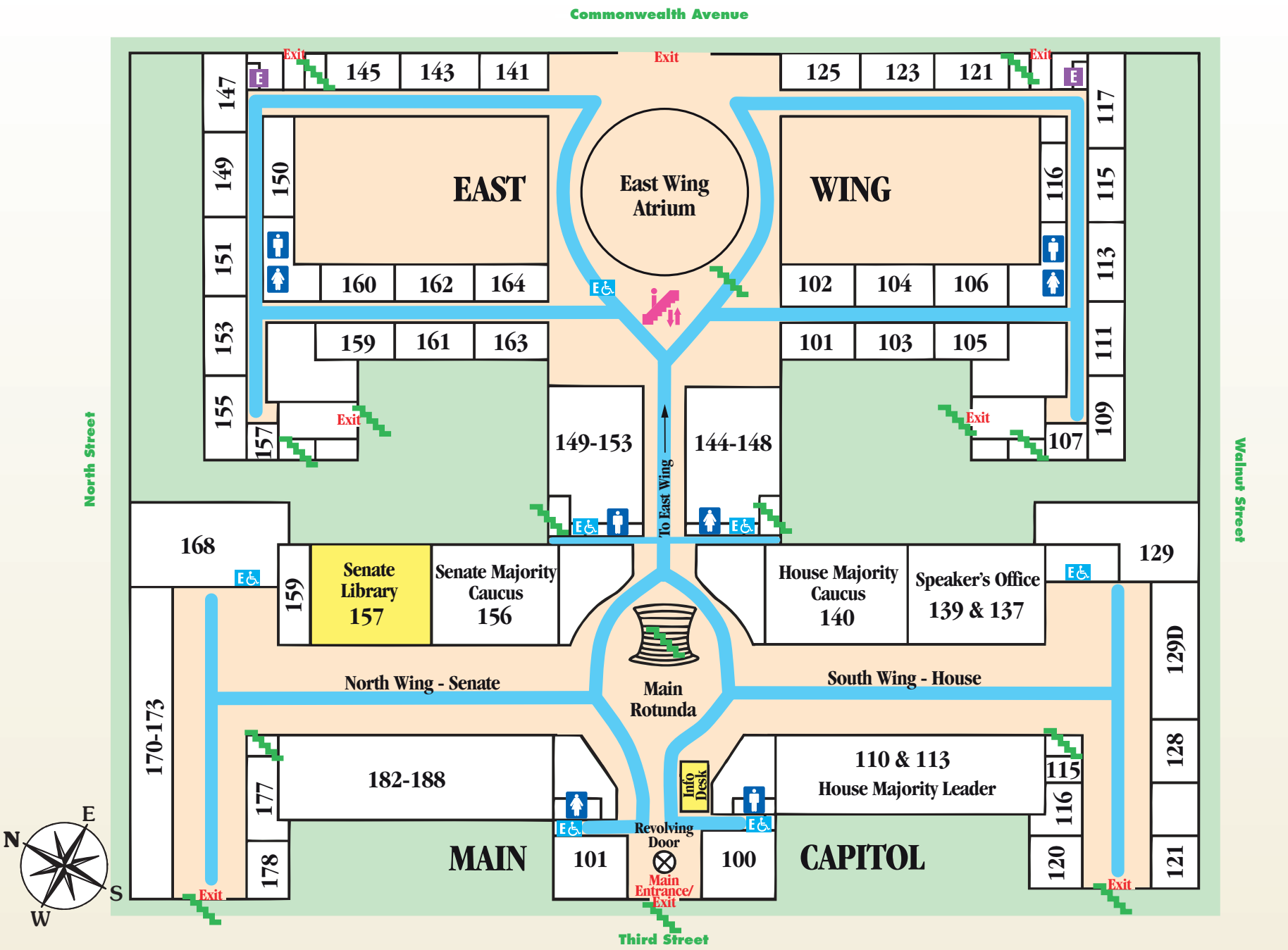

Main Capitol First Floor and Upper Level East Wing